

Top Seller X-Rail

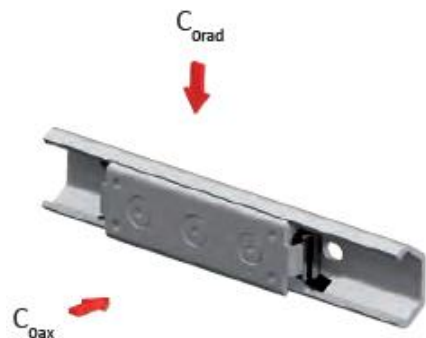

KFS – mit Kompaktkorpus
KFS – with compact body

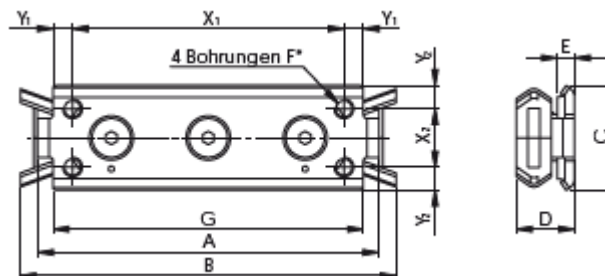

MFS – mit Massivkorpus
MFS – with solid body

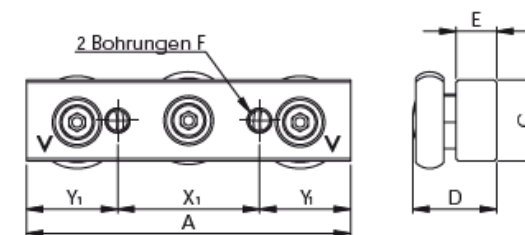

KFS/MFS Läufer (Rollon CES)
KFS/MFS slider (Rollon CES)

Typ	# Rollen	[N]		[mm]											[kg]
		C_{0rad}	C_{0ax}	A	B	C	D	E	G	X1	Y1	X2	Y2	F	Gewicht
KFS20-80-3-2Z	3	326	185	80	90	18	11.5	5.5	71	60	5.5	-	9	M5	0.05
KFS30-88-3-2Z	3	870	435	88	97	27	15	4.5	80	70	5	15	6	M5	0.11
MFS20-60-3-2Z	3	326	185	60	-	10	13	6	-	20	20	-	-	M5	0.04
MFS30-80-3-2Z	3	870	435	80	-	20	20.7	10	-	35	22.5	-	-	M6	0.17

PFS Schiene (Rollon TES)
PFS rail (Rollon TES)

Typ	[mm]					Schraubenbohrungen	[kg/m]	[mm]
	A	B	C	D	E		Gewicht	Längen
PFS20	19.2	10	2	7	3	M4	0.47	160 – 3120
PFS30	29.5	15	2.5	10	4.5	M5	0.9	(alle 80mm)

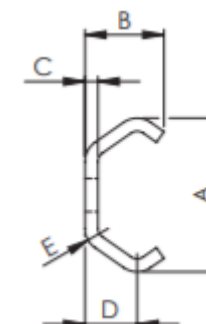

Unser ganzes Sortiment von Läufer und Schienen finden Sie im Gesamtkatalog. Bei Fragen helfen unsere Berater gerne weiter.
You will find our entire range of sliders and rails in the general catalogue. If you have any questions, our advisors will be happy to help.